

Panasonic®

Operating Instructions

Easy Use Mobile Phone

Model No. **KX-TU329 FX**



Thank you for purchasing a Panasonic product.

Please read these operating instructions before using the unit and save them for future reference.

Before initial use, see “Important Information” on page 12.

Supplied accessories

- AC adaptor (Part No. PNLV230CE): 1 pc
- Rechargeable battery (Part No. BJ-LT100010): 1 pc
- Charger: 1 pc

Table of Contents

Getting Started		Customising Your Phone	
Setting up	3	Menu list	41
Controls	6	Connecting to Other Devices	
Display	7	Using the FM radio	49
Turning the power on/off	10	Using a Bluetooth® wireless connection	51
Initial settings	10	Using a USB connection	54
Important Information		Useful Information	
For your safety	12	Troubleshooting	55
Important safety instructions	14	General information	58
For best performance	15	Sales department	59
Other information	15	Declaration of conformity form	60
SAR	16	Index	
Specifications	17	Index.....	62
Basic Operations			
Making calls	18		
Answering calls	19		
Call log	20		
Voicemail service	20		
Text input	21		
Messages	21		
Phonebook	25		
Alarm	27		
Night mode	28		
Calendar/Schedule	29		
Voice recording	30		
Priority call	31		
Network service call features	33		
Security settings	34		
Camera	35		
Image viewer	37		
File manager	38		

Setting up

Inserting a SIM card, microSD card, and the battery

A SIM card (not supplied) allows the phone to connect to a mobile phone service. Contact your network operator/service provider for more information.

A microSD card (not supplied) allows you to expand the phone's storage capabilities.

Important:

- When removing the battery, make sure you turn off the phone first.
- To avoid loss of data or malfunction, do not damage, carelessly handle, or short-circuit the gold-coloured contacts of the SIM card or microSD card.

- 1 Remove the phone's cover.

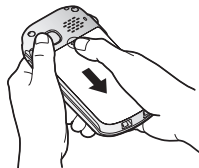

- 2 Open the SIM card cover by sliding it toward the nearest side of the phone (①) and then lifting up (②).

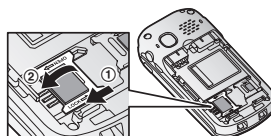

- 3 Put the SIM card with the gold-coloured contacts facing down.

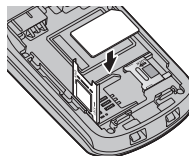

Getting Started

- 4 Close the SIM card cover (①), and then gently slide the cover toward the opposite side of the phone (②).

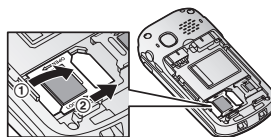

- 5 Open the microSD card cover by sliding it toward the nearest side of the phone (①) and then lifting up (②).

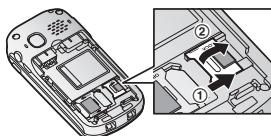

- 6 Put the microSD card with the gold-coloured contacts facing down, close the microSD card cover (①), and then gently slide the cover toward the opposite side of the phone (②).

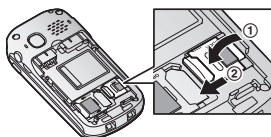

- 7 Insert the battery (①) and lower it into the phone (②), then attach the cover (③).

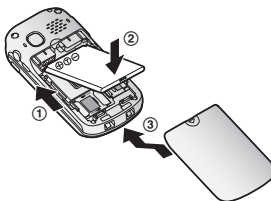

Note:

- Use only the battery specified.
- Wipe the battery ends (⊕, ⊖), SIM card, and microSD card with a dry cloth.
- Avoid touching the battery ends (⊕, ⊖) or the unit contacts.
- After installing the SIM card, microSD card, and battery, press **[⏻]** for about 2 seconds to turn the power on (page 10).

Battery charging

You can charge the battery by connecting the phone to a power outlet using the supplied AC adaptor, either directly or by using the charger, or by connecting it to a computer using a USB cable (not supplied).

- Charge for about 3 hours.
- **Charging time and battery life might differ depending on the condition of the network.**
- When using an AC adaptor, use only the supplied AC adaptor.
- When charging begins, the phone sounds and the battery indicator lights. When the battery is fully charged, the battery indicator turns off.

◆ AC adaptor or USB connection

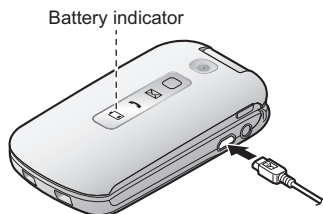

◆ Using the charger

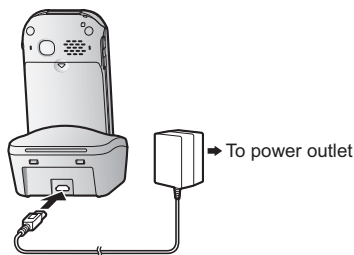

Note:

- The battery might swell when its life is close to an end. This is dependent on the usage conditions and is not a problem.
- It is normal for the phone and AC adaptor to feel warm during charging.

Getting Started

Controls

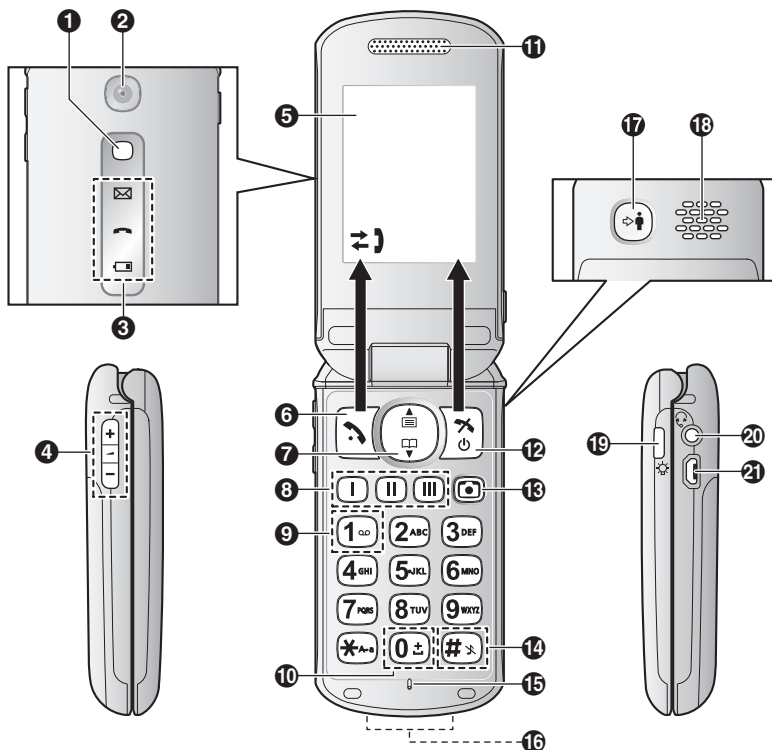





















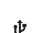

- | | |
|--|--|
| <ul style="list-style-type: none"> 1 LED light 2 Camera lens 3 LED status indicator;
page 9 4 Volume up/down
Change font display size;
page 10 5 Display; page 7 | <ul style="list-style-type: none"> 6 Make calls/Answer calls/
Select the function shown
above (page 9). 7 Navigation key
[▲] (☰): Open the main menu.
[▼] (☷): View the contacts
list. 8 One touch dial key; page 18 |
|--|--|

Getting Started

































- | | |
|--|---|
| <ul style="list-style-type: none"> 9 Call voicemail; page 21 10 International call; page 18 11 Receiver 12 Power/End calls/Select the function shown above (page 9). 13 Camera key; page 35 14 Press and hold for 2 seconds to turn the silent mode on/off. 15 Microphone | <ul style="list-style-type: none"> 16 Charge contacts 17 Priority call; page 31 18 Speaker 19 Press to turn the light on/off (page 36). 20 Headset jack 21 USB connector (Micro-B type); page 5, 54 |
|--|---|

Display



Symbols

- | | |
|---|---|
| <ul style="list-style-type: none">  Signal strength  R: Roaming network  E: The phone is connected to an EDGE network.  G: The phone is connected to a GPRS network.  Battery level <ul style="list-style-type: none">  High  Medium  Low  Needs charging.  The phone is connected to a computer via USB.  The call is not encrypted.^{*1}  Silent mode is on. (page 7, 47)  Vibration is on. (page 47)  Handsfree is on. (page 19) | <ul style="list-style-type: none">  Ringer volume off.  Incoming call  Outgoing call  Missed call  Mute is on. (page 19)  Frequency control equalizer is set. (page 19)  A 2nd call is on hold.  <ul style="list-style-type: none"> ● Contact is saved to the phone. ● Root directory of phone ● Mobile phone is discovered in Bluetooth search menu.  Contact is saved to the SIM card.  Contact name |
|---|---|

Getting Started

	Mobile phone number		– Image file
	Office phone number		– Image file is attached to the MMS message.
	Home phone number		– Image file is selected for caller picture.
	Fax number		Root directory of memory card
	Selected ringer tone.		– Sound file
	<ul style="list-style-type: none"> ● New SMS message is received. ● SMS message (unread/unsent) is saved to the phone. 		– Sound file is attached to the MMS message.
	SMS message (sent) is saved to the phone.		VCF (vCard) file
	SMS message (opened) is saved to the phone.		Other format file
	SMS message (unread/unsent) is saved to the SIM card.		Other format file is attached to the MMS message.
	SMS message (sent) is saved to the SIM card.		Folder
	SMS message (opened) is saved to the SIM card.		MMS recipient is set to To.
	MMS is running for sending or receiving data.		MMS recipient is set to Cc.
	<ul style="list-style-type: none"> ● New MMS message is received. – Flashing: Message memory is full. ● MMS message is unread or unsent. 		MMS recipient is set to Bcc.
	MMS message is read.		New voicemail message received.* ² (page 21)
	MMS message is unreceived.		Alarm is on. (page 27, 29)
	MMS message is sent.		Night mode is on. (page 28)
			Headset (optional) is connected.
			<ul style="list-style-type: none"> – Bluetooth feature is on. (page 51) – Another Bluetooth device is connected.
			Bluetooth compatible computer is discovered in Bluetooth search menu.

Getting Started











-  Bluetooth headset is discovered in Bluetooth search menu.
-  Bluetooth headset is connected to the phone.









-  Bluetooth hands-free car kit is discovered in Bluetooth search menu.

*1 Contact your network operator/service provider for more information.



*2 Voicemail subscribers only

Function keys

-  Calls emergency number.
-  Returns to previous screen.
-  Accepts current selection.
-  Erases a number/character.
-  Opens recent call log.
-  Makes/answers a call.
-  Ends the call.
-  Sets handsfree.
-  Opens option menu.
-  Answers a 2nd call.

-  Allows editing.
-  Selects multiple items.
-  Stops alarm.
-  Activates snooze function.
-  Turns the power off.
-  Pauses playback.
-  Resumes playback.
-  Stops recording or playback.

LED status indicator

-  Message indicator
Flashes when a new message is received.*1
-  Incoming call indicator
Flashes when there is an incoming call, when you have a missed call*1, or while talking.

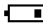
-  Battery indicator
Turns on when charging.
– Flashing: The battery is low.

*1 Message indicator and incoming call indicator stop flashing after about 12 hours have passed.

Getting Started

Turning the power on/off

Press **[]** for about 2 seconds.





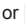

- The phone vibrates when you turn the power on.

Note:







- Enter the PIN1 code and press **[]** or **[# ]** when the PIN1 code request is displayed (page 34).
- The display becomes dark when you do not operate the phone for about 1 minute. Press any key to turn the display back on.

Initial settings

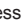
The phone may prompt you to set display language, time zone, and date and time each time a new SIM card is installed.

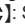
- 1 **[]**: Select the desired language. → **[]**
- 2 **[]**: Select the desired time zone. → **[]**
- 3 Enter the current date, month, and year. → **[]**
- 4 Enter the current time. → **[]**

Note:

- If you select a language you cannot read:
Press **[]**. → **[]**: Select . → **[]** 2 times → **[]** 2 times → **[]** → **[]**: Select the desired language. → **[]**
- If you want to change the date and/or time format, see page 46.
- To adjust the hour for summer time, see page 46.

Display font size

Press **[+]** or **[-]** to adjust the font size of displayed menus.

Note:

- You cannot adjust the display font size while you are on a call or the phone is ringing for an incoming call.

Changing the ringer tone

You can change the ringer tone by selecting one of the preset tones (“Using a preset ringer tone”, page 11) or by selecting one of your own sound files (including sounds recorded using the phone’

s voice recorder) for use as a ringer tone (“Using your own sound file”, page 11).

Using a preset ringer tone

- 1 Press [▲]. → [⏮]: Select ♪. → [↶]
- 2 [⏮]: “General” → [↶]
- 3 [⏮]: “Customize” → [↶]
- 4 [⏮]: “Ringtone” → [↶]
- 5 [⏮]: Select the desired ringer tone. → [↶]

Using your own sound file

Before you can use your own sound file as a ringer tone, you must first prepare it for use as a ringer tone.

- 1 Press [▲]. → [⏮]: Select ♪. → [↶]
- 2 [⏮]: “General” → [↶]
- 3 [⏮]: “Customize” → [↶]
- 4 [⏮]: “Ringtone” → [↶]
- 5 [⏮]: “Select from File” → [↶]
- 6 [⏮]: Select the desired memory location (root directory). → [↶]
- 7 [⏮]: Select the desired folder and/or file. → [↶]
 - The name of the selected sound file is displayed in the list.

Audible dialling

When you turn this feature on, numbers are announced when pressing dial keys. To change this setting, see page 47.

Important Information

For your safety

Read this section carefully before using the product to ensure proper and safe operation. Failure to read them carefully may cause severe injury, loss of life/property, or be illegal.

WARNING

Power connection

- Use only the power source marked on the product.
- Do not overload power outlets and extension cords. This can result in the risk of fire or electric shock.
- Completely insert the AC adaptor into the power outlet. Failure to do so may cause electric shock and/or excessive heat resulting in a fire.
- Regularly remove any dust, etc. from the AC adaptor by pulling it from the power outlet, then wiping with a dry cloth. Accumulated dust may cause an insulation defect from moisture, etc. resulting in a fire.
- Unplug the product from power outlets and remove the battery from the phone if it emits smoke, an abnormal smell, or makes an unusual noise. These conditions can cause fire or electric shock. Confirm that smoke has stopped emitting and contact an authorised service centre.
- Unplug from power outlets and never touch the inside of the product if its casing has been broken open.
- Never touch the plug with wet hands. Danger of electric shock exists.
- The AC adaptor should only be used indoors.
- Do not use the supplied AC adaptor with other devices.

Installation

- This product is not water-resistant. To prevent the risk of fire or electrical shock, do not expose the product to rain or any type of moisture.
- Keep all accessories, including the SIM card and microSD card, out of the reach of children to prevent swallowing.
- This product emits radio waves and may cause interference to other electronic devices.
- Do not allow the AC adaptor to be excessively pulled, bent or placed under heavy objects.
- To prevent serious damage to this product, avoid strong impacts and rough handling.
- To avoid damage or malfunction, do not modify the SIM card or microSD card or touch the card's gold-coloured contacts.

Battery

- Use only the battery specified.
- Risk of explosion if battery is replaced with an incorrect type. Dispose of used batteries according to the instructions.
- Do not open, puncture, crush, or drop the battery. A damaged battery must not be used. This can result in the risk of fire, explosion, overheating, and leaking of the electrolyte.
- Stop using the battery immediately and keep away from fire if it emits an abnormal smell or leaks electrolyte. Released electrolyte may cause fire or burns.

Important Information

- Do not touch released electrolyte if the battery leaks. It may cause burns or injury to the eyes or skin. The electrolyte is toxic and may be harmful if swallowed. If you touch it, immediately wash the affected areas with water and seek medical help.
- Exercise care when handling the battery. Do not allow conductive materials such as rings, bracelets, or keys to touch the battery, otherwise a short circuit may cause the battery and/or the conductive material to overheat and cause burns.
- Do not use or charge a wet battery. This can result in the risk of fire, explosion, overheating, and leaking of the electrolyte.
- Charge the battery provided with or identified for use with this product only, in accordance with the instructions and limitations specified in this manual.
- Only use a compatible charger to charge the battery. Do not tamper with the charger. Failure to follow these instructions may cause the battery to swell or explode.
- Do not put any conductive materials such as coins or hairpins onto the charge contacts. This can result in the risk of overheating.

Operating safeguards

- Unplug the product from power outlets before cleaning. Do not use liquid or aerosol cleaners.
- Do not disassemble the product.
- Do not allow liquids such as water, or foreign materials such as metal pieces or flammable materials to get into the SIM card holder. This can result in the risk of fire, electric shock, or malfunction.
- Do not leave this product near heat sources (such as radiators, cookers, etc.), in direct sunlight, or in a car under blazing sun. It should not be placed in rooms where the temperature is less than 0 °C or greater than 40 °C.
- You are advised not to use the phone in an aircraft. Turn the phone off before boarding an aircraft. Set the alarm function off so that the phone cannot be automatically turned on. Using this phone in an aircraft may be hazardous to the aircraft's operation and disrupt wireless communication. It may also be illegal.
- You are advised not to use this product at refuelling points. Users are reminded to observe restrictions on the use of radio equipment in fuel depots, chemical plants or where blasting operations are in progress.
- It is imperative that drivers exercise proper control of vehicles at all times. Do not use a phone while you are driving; find a safe place to stop first. Do not speak into a hands free microphone if it will take your mind off the road. Always acquaint yourself thoroughly with restrictions concerning the use of phones within the area where you are driving and observe them at all times.
- RF signals may affect electronic systems in motor vehicles (for example, fuel injection, air bag systems) that have been improperly installed or are inadequately shielded. For more information, consult the manufacturer of your vehicle or its equipment.
- The use of excessive sound volume through earphones, headphones, or headsets may cause hearing loss.
- To prevent possible hearing damage, do not listen at high volume levels for long periods.



- Do not shine the LED light close to anybody's eyes or turn the LED light in the direction of car drivers. This can result in the risk of injuries or accident.

Important Information

Medical

- Consult the manufacturer of any personal medical devices, such as pacemakers or implanted cardioverter defibrillators to determine if they are adequately shielded from external RF (radio frequency) energy.
- Wireless Technology Research (WTR) recommends a minimum separation of 15.3 cm between a wireless device and an implanted medical device such as pacemaker or implanted cardioverter defibrillator to avoid potential interference with the medical device. If you have any reason to suspect that your phone is interfering with a pacemaker or other medical devices, turn off the phone immediately and contact the manufacture of pacemaker or other medical devices.
- Turn off the phone in hospitals or health care facilities when any regulations posted in the area instruct you to do so. Hospitals or health care facilities may be using equipment that could be sensitive to external RF energy.

Hearing aids

- This phone is hearing aid compatible and is rated equivalent to the M3/T4 rating of the ANSI C63.19 test method. Most hearing aids on the market should be compatible with this product but compatibility is not guaranteed. Please consult with your Doctor or hearing aid manufacturer before using a hearing aid with this product.

CAUTION

Installation

- The AC adaptor is used as the main disconnect device. Ensure that the AC outlet is installed near the product and is easily accessible.
- It is recommended that you keep a written record of any important data which you store in your phone or SIM card in order to avoid accidental loss.

Operating environment

- Do not place magnetic cards or similar objects near the phone. Magnetic data on cash cards, credit cards, telephone cards and floppy disks, etc. may be deleted.
- Do not put magnetic substances close to the phone. Strong magnetism might affect operation.

Important safety instructions

When using your product, basic safety precautions should always be followed to reduce the risk of fire, electric shock, and injury to persons, including the following:

1. Do not use this product near water. For example, avoid areas near a bathtub, washbowl, kitchen sink, laundry tub, or swimming pool.
2. Avoid using the phone if charging during an electrical storm. There may be a remote risk of electric shock from lightning.
3. Do not use the phone to report a gas leak in the vicinity of the leak.
4. Use only the power cord and battery indicated in this manual. Do not dispose of the battery in a fire. It may explode. Check with local codes for possible special disposal instructions.
5. Do not paint or attach a thick sticker to the phone. This may prevent proper operation.

Important Information

SAVE THESE INSTRUCTIONS

For best performance

Environment

- The product should be kept free from excessive smoke, dust, moisture, high temperature and vibration.
- To avoid damage, charge the battery only in temperatures ranging from 5 °C to 40 °C.

Routine care

- **Wipe the outer surface of the product and/or charge contacts with a soft and dry cloth.**
- Do not use benzine, thinner, or any abrasive powder.

Other information

Notice for product disposal, transfer, or return

- This product and SIM card can store your private/confidential information. To protect your privacy/confidentiality, we recommend that you erase information such as contacts stored in the contacts list, call logs, and SMS/MMS messages from the memory before you dispose of, transfer, or return the product.

Information for Users on Collection and Disposal of Old Equipment and used Batteries

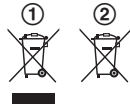

These symbols (①, ②) on the products, packaging, and/or accompanying documents mean that used electrical and electronic products and batteries must not be mixed with general household waste.

For proper treatment, recovery and recycling of old products and batteries, please take them to applicable collection points in accordance with your national legislation.

By disposing of them correctly, you will help to save valuable resources and prevent any potential negative effects on human health and the environment.

For more information about collection and recycling, please contact your local municipality.

Penalties may be applicable for incorrect disposal of this waste, in accordance with national legislation.

For business users in the European Union

If you wish to discard electrical and electronic equipment, please contact your dealer or supplier for further information.

Important Information

Information on Disposal in other Countries outside the European Union

These symbols (①, ②) are only valid in the European Union. If you wish to discard these items, please contact your local authorities or dealer and ask for the correct method of disposal.

Note for the battery symbol

This symbol (②) might be used in combination with a chemical symbol. In this case it complies with the requirement set by the Directive for the chemical involved.

Note for the battery removal procedure

Remove the phone's cover (①), and lift the battery (②), then remove it (③).

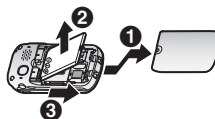

Trademarks

- microSDHC Logo is a trademark of SD-3C, LLC.
- The Bluetooth® word mark and logos are registered trademarks owned by Bluetooth SIG, Inc., and any use of such marks by Panasonic Corporation is under licence.
- All other trademarks identified herein are the property of their respective owners.

Notice

- The phone supports microSD and microSDHC memory cards. In this document, the term "microSD card" is used as a generic term for any of the supported cards.

Ecodesign information

Ecodesign information under EU Regulation (EC) No. 1275/2008 amended by (EU) Regulation No. 801/2013. From 1 January 2015.

Please visit here: <http://www.ptc.panasonic.eu/erp>

Click [Downloads]

→ Energy related products information (Public)

Power consumption in networked standby and guidance are mentioned in the web site above.

SAR

This model meets international guidelines and EU requirements for exposure to radio waves. Your wireless device is a radio transmitter and receiver. It is designed not to exceed radio wave exposure limits recommended by international guidelines. These guidelines were developed by the independent scientific organisation ICNIRP and include safety margins designed to assure

Important Information

the protection of all persons, regardless of age and health. These guidelines also form the basis of international regulations and standards on RF Exposure.

The guidelines use a unit of measurement known as the Specific Absorption Rate, or SAR. The SAR limit for wireless devices is 2 W/kg.

The highest SAR value for this device tested at the head was: 0.283 W/kg

The highest SAR value for this device tested on the body was: 1.10 W/kg^{*1}

As SAR is measured utilizing the devices highest transmitting power the actual SAR of this unit while operating is typically below that indicated above. This is due to automatic changes to the power level of the device to ensure it only uses the minimum level required to communicate with the network.

ICNIRP (<http://www.icnirp.org>)

*1 This device was tested for typical body-worn operation with the back of the phone kept 0.5 cm from the body.

Specifications

- **Standard:**
Dual band GSM 900/1800 MHz
Bluetooth version 3.0, Class 2
USB version 1.1
- **Display:** TFT colour 2.4-inch
(QVGA: 240 x 320 pixels)
- **Camera:** 2MP
- **Frequency range:**
GSM 900: 880-915 MHz/925-960 MHz
GSM 1800: 1710-1785 MHz/
1805-1880 MHz
Bluetooth: 2.402-2.48 GHz
- **RF transmission power:**
GSM 900: 2 W (max.), GSM 1800: 1 W (max.)
Bluetooth: 2.5 mW (max.)
- **Power source:**
100–240 V AC, 50/60 Hz
- **Power consumption (when charging):**
Standby: Approx. 0.2 W
Maximum: Approx. 4.0 W
- **Operating/Charging conditions:**
Operating: 0 °C – 40 °C, 20 % – 80 %
relative air humidity (dry)
Charging: 5 °C – 40 °C
- **Battery:** Li-Ion 3.7 V/1,020 mAh
- **Battery performance (supplied):**
Talk time: Approx. 5.0 hours^{*1}
Standby time: Approx. 600 hours^{*1, *2}
- **Antenna:** Internal
- **SIM card type:** 1.8 V/3 V
- **Memory card type:**
microSD, microSDHC up to 32GB (not
supplied)
- **Shock resistant:**
This product has cleared the drop test
stipulated by "MIL-STD-810E.516".

*1 Operating time is dependent upon usage environment, battery age and condition. Values were calculated according to GSMA TS.09.

*2 The incoming call indicator and message indicator flash when there is a missed call or a new message is received. The standby time will be shortened when you leave the indicator flashing.

Basic Operations

Making calls

- 1 Enter the phone number (40 digits max.).
 - Press **[✕⏻]** to clear the previous digit.
- 2 Press **[↶]** to dial.
 - To switch to a handsfree, press **[↶]** while **[📞]** is displayed.
- 3 Press **[✕⏻]** to end the call.
 - You can also end the call by simply closing the phone.

Note:

- To make an international call, press and hold **[0 +]** until “+” (the international prefix) is displayed.
- To insert a pause (3 seconds per pause), press and hold **[✕]** until “p” is displayed.

Making a call using the call log

- 1 Press **[↶]** to display the call log in standby mode.
- 2 **[↕]**: Select the desired party. → **[↶]**

Making a call using the phonebook

To store a contact, see page 25.

- 1 Press **[▼]** in standby mode.
 - To change the search language:
[# ↻] → [↕]: Select the desired language. → **[↶]**
 - Press a dial key (**[0]** to **[9]**) repeatedly to display the contact corresponding to that key.
- 2 **[↕]**: Select the desired contact. → **[↶]**
 - If multiple phone numbers are stored in a contact, all phone numbers are displayed.
[↕]: Select the desired phone number. → **[↶]**

Making a call using a one touch dial key

To assign a contact to a one touch dial key, see page 26.

Press and hold the desired one touch dial key (**[I]** to **[III]**).

- Press the one touch dial keys to see the assigned number/name.

Making a call using a speed dial key

To assign a contact to a speed dial key, see page 26.

Press and hold the desired speed dial key (**[2]** to **[9]**). → **[↶]**

Call options

While talking, the following options are available by pressing [**⌂**]:

- **“Hold”/“Retrieve”**: puts a call on hold/releases hold (page 33).
- **“Equalizer”**: clarifies the voice of the person you are talking to.
- **“Mute On”/“Mute Off”**: turns the mute on/off.
- **“Handsfree On”/“Handsfree Off”**: enables/disables handsfree.
- **“Phonebook”**: views the contacts list.
- **“Call Log”**: enters the call log menu (page 43).
- **“Messages”**: enters the message menu (page 41).

Answering calls

When a call is being received, the incoming call indicator flashes rapidly (page 9).

1 Press [**⌂**] to answer.

- To answer a call by opening the phone, see page 44.
- To reject the call, press [**⌂**].

2 Press [**⌂**] to end the call.

Note:

- This phone can announce the caller's phone number after every ring when a call is received. To use this feature, turn the caller ID readout feature on (page 47).

Missed calls

If a call is not answered, the phone treats it as a missed call.

“Missed Call” and the number of missed calls are shown on the display. You can view the missed call log by pressing [**⌂**] when it is displayed.

Basic Operations

Call log

Incoming, outgoing, and missed calls are stored in a call log (maximum 10 calls each).

Note:

- When a caller's phone number matches a phone number stored in the contacts list, the stored name is displayed and logged.
 - “Unknown Number”: The caller's information could not be received.
 - “Withheld”: The caller requests not to send their phone number.

Call log options

Press [▲]. → [⬆]: Select ☰. → [↶] → [⬆]: “Call Log” → [↶] → [⬆]: Select a call log list. → [↶] → [⬆]: Select a log. → [↶] → [↶]:

- “Call”
- “Send SMS”
- “Send MMS”
- “Add Phonebook”
- “Use Number”
- “Delete”

Voicemail service

Voicemail is an automatic answering service offered by your network. Contact your network operator/service provider for details. You must first confirm that the correct voicemail access number is stored.

Storing the voicemail access number

- 1 Press [▲]. → [⬆]: Select ☑. → [↶]
- 2 [⬆]: “Settings” → [↶]
- 3 [⬆]: “SMS” → [↶]

- 4 **[↕]**: “Voicemail” → **[↶]**
- 5 **[↕]**: “Edit” → **[↶]**
- 6 Enter the voicemail access number (20 digits max.). → **[↶]**

Listening to voicemail messages

- 1 Press and hold **[1[∞]]** when in standby mode.
- 2 Press **[↶⓪]** to end the call.

Text input

Press the dial keys to input characters and numbers. Each dial key has multiple characters assigned to it. The assigned characters for each key will be displayed when you press the key.

- Press **[↵]** or **[↶]** to move the cursor right or left.
- Press and hold **[↶]** or **[↵]** to move the cursor up or down.
- Press **[↶⓪]** to erase the character or number to the left of the cursor.
- To insert a space, press **[0 ±]** or select “_” in the symbol list.
- Press **[*]** (A→a) to change the input letter case. For example, lower case (abc/абв), auto case (Abc/Абв), upper case (ABC/АБВ), and numeric (123).
- **To select a symbol:**
 - [# ↲] → [↕]**: Select the desired symbol. → **[↶]**
 - ↲ is used only for SMS/MMS message entries.
- **To change the input language:**
 - [↶] → [↕]**: “Input Language” → **[↶] → [↕]**: Select the desired input language. → **[↶]**

Messages

You can send and receive text messages using SMS (Short Message Service). If you have subscribed to a network service that

Basic Operations

supports MMS (Multimedia Messaging Service), you can also send and receive messages containing pictures, sound, or contacts lists using MMS. For details and the availability of these services, contact your network operator/service provider.

Creating and sending an SMS message

- 1 Press [▲]. → [⬆]: Select [✉]. → [↶]
- 2 [⬆]: “Create Message” → [↶]
- 3 [⬆]: “SMS” → [↶]
- 4 Enter a message (page 21).
- 5 [↶] → [⬆]: “Send to” → [↶]
 - To save the message, select “Save to Drafts”.
- 6 ♦ **To add the phone number manually:**
 - [⬆]: “Manual Input” → [↶] → Enter destination phone number (20 digits max.). → [↶]
- ♦ **To use the contacts list:**
 - [⬆]: “Add from List” → [↶] → [⬆]: Select the desired contact. → [↶]
 - To add another recipient, repeat from this step.
- 7 [↶] → [⬆]: “Send” → [↶]

Note:

- If your SMS message contains over 160 characters (70 characters depending on character type), it is a long message. You can send or receive a long message of up to 612 or 268 characters depending on character type. Your network operator/service provider may treat long messages differently from other SMS messages. Contact your network operator/service provider for details.
 - You cannot send or receive SMS messages containing pictures, sound, or contacts list.
-

Creating and sending an MMS message

- 1 Press [▲]. → [⬆]: Select [✉]. → [↶]
 - 2 [⬆]: “Create Message” → [↶]
 - 3 [⬆]: “MMS” → [↶]
 - 4 Enter a message (page 21). → [↶]
-

- 5 ♦ **To add a picture file:**
 - [↕]: “Add Picture” → [↶] → [↕]: “My Picture”
- ♦ **To add a sound file:**
 - [↕]: “Add Sound” → [↶] → [↕]: “My Sound”
- ♦ **To add a file as an attachment:**
 - [↕]: “Advanced” → [↶] → [↕]: “Insert Att.”
- 6 [↶] → [↕]: Select the desired memory location (root directory). → [↶] → [↕]: Select the desired folder and/or file. → [↶]
- 7 [↶] → [↕]: “Add Subject” → [↶] → Enter a subject (page 21). → [↶] → [↕]: “Save” → [↶]
- 8 [↶] → [↕]: Select “Preview MMS” to confirm the content. → [↶] → After confirmation, press [✕].
 - Press [▼] or [▲] repeatedly to fully display the message and attachment while previewing.
- 9 [↶] → [↕]: “Send to” → [↶]
 - To save the message, select “Save to Drafts”.
- 10 ♦ **To add the phone number manually:**
 - [↕]: “Manual Input” → [↶] → Enter the destination phone number (20 digits max.) or E-mail address (64 characters max., page 21). → [↶]
- ♦ **To use the contact list:**
 - [↕]: “Add from List” → [↶] → Select the desired contact. → [↶]
 - To add another recipient, repeat this step.
 - If you do not want to change the recipient's attribute to Cc or Bcc, go to step 12.
- 11 [↕]: Select the desired recipient to change its attribute to Cc or Bcc if necessary. → [↶] → [↕]: Select “Change to Cc” or “Change to Bcc”. → [↶]
 - To change another recipient's attribute, repeat this step.
- 12 [↶] → [↕]: “Send” → [↶]

Basic Operations

Reading a received message

- 1 Press [▲]. → [⬆]: Select [✉]. → [↶]
 - 2 [⬆]: “Inbox” → [↶]
 - 3 [⬆]: Select a message.
 - To scroll through the messages, press and hold [▼] or [▲].
 - 4 Press [↶] to read the message.
-

Replying to a message

- 1 While reading a message, press [↶].
 - 2 [⬆]: Select “Reply by SMS” or “Reply by MMS”. → [↶]
 - 3 ♦ **To reply a message by SMS :**
 - Continue from step 4 in “Creating and sending an SMS message”, page 22.
 - ♦ **To reply a message by MMS :**
 - Continue from step 4 in “Creating and sending an MMS message”, page 22.
-

Messages options

Press [▲]. → [⬆]: Select [✉]. → [↶] → [⬆]: Select a desired box. → [↶] → [⬆]: Select a message. → [↶] → [↶]:

- “Reply by SMS”
 - “Reply by MMS”
 - “Call Sender”
 - “Forward Message”
 - “Add Phonebook”
 - “Delete”
 - “Extract Number”
 - “Edit Message”
 - “Resend”
-

- If an MMS message is selected, the following options are also available.
 - “View”
 - “Reply to All”
 - “Cancel Send”
 - “Save Objects”
 - “Move to Phone”/“Move to SD Card”
 - “Copy to Phone”/“Copy to SD Card”
 - “Message Status”
 - “Detail”

Phonebook

You can store contacts in the phone (up to 200 contacts with 4 phone numbers for each contact) or SIM card by changing the memory location (page 43).

You can customise the ringer tone and picture assigned to each contact.

Note:

- For other phonebook settings, see page 43.

Creating contacts

- 1 Press [▲]. → [↕]: Select . → [↶]
- 2 [↕]: “Add New Contact” → [↶]
- 3 [↕]: “Name” → [↶]
- 4 Enter the party's name (page 21).
- 5 [↶] → [↕]: “Save” → [↶]
- 6 [↕]: “Phone num. 1” → [↶]
 - When the selected memory location is a SIM card, select “Number”.
- 7 Enter the party's phone number. → [↶]
 - When the selected memory location is a SIM card, go to step 15.

Basic Operations

- 8 [↕]: Select an icon if necessary. → [↶]
 - If you want to store another phone number, select either “Phone num. 2”, “Phone num. 3”, or “Phone num. 4”.
- 9 [↕]: “General” → [↶]
- 10 [↕]: Select the desired ringer tone if necessary. → [↶]
 - If you want to use one of your own sound files as the contact’s ringer tone, continue from step 5 in “Using your own sound file”, page 11.
 - If you do not want to add a picture, skip the next step and continue from step 15.
- 11 [↕]: “Caller Picture” → [↶]
- 12 [↕]: Select the desired memory location (root directory). → [↶]
- 13 [↕]: Select the desired folder and/or file. → [↶]
- 14 Press [↶] to confirm the setting.
 -  and “File Selected” is displayed in the list.
- 15 [↕]: “Save” → [↶]

Assigning a contact to a one touch dial key

- 1 Press [▲]. → [↕]: Select . → [↶]
- 2 [↕]: “One Touch Dial” → [↶]
- 3 [↕]: Select the desired one touch dial key number.
- 4 [↶] → [↕]: “Add from List” → [↶]
- 5 [↕]: Select the desired contact. → [↶]

Assigning a contact to a speed dial key

- 1 Press [▲]. → [↕]: Select . → [↶]
- 2 [↕]: “Speed Dial” → [↶]
- 3 [↕]: Select the desired dial key number.
- 4 [↶] → [↕]: “Add from List” → [↶]
- 5 [↕]: Select the desired contact. → [↶]

Contacts list options

Press [▲]. → [◆]: Select . → [↶] → [◆]: “Contacts” → [↶] → [◆]: Select a contact. → [↶]:

- “Call”
- “Detail”
- “Edit”
- “Create Message”
- “Use Number”
- “Add New Contact”
- “Send vCard”
- “Copy”
- “Delete”
- “Search Letter”

Alarm

You can set an alarm to sound for 30 seconds at the specified time. You can also select the sound used as the alarm tone. The snooze function will cause it to repeat 3 times at 5 minutes intervals. While the alarm is sounding, a text memo is displayed. A total of 5 separate alarm times can be programmed. The phone vibrates when the silent mode is on.

- 1 Press [▲]. → [◆]: Select . → [↶]
- 2 [◆]: “Alarm” → [↶]
- 3 [◆]: Select an alarm. → [↶]
- 4 [◆]: “Settings” → [↶]
- 5 Set the desired time. → [↶]
- 6 [◆]: Select the desired alarm option. → [↶]
 - “Once”: Alarm sounds once at the set time. Go to step 9.
 - “Weekly”: Alarm sounds weekly at the set time(s).

Basic Operations

- 7 [↕]: Select the desired day of the week and press [↵].
- 8 [↕]: “Save” → [↵]
- 9 Enter/edit a text memo if necessary (page 21).
- 10 [↵] → [↕]: “Save” → [↵]
- 11 [↕]: Select the desired alarm tone. → [↵]
 - If you want to use one of your own sound files as the alarm tone, continue from step 5 in “Using your own sound file”, page 11.
 - “✓” is displayed next to the set alarm.

Note:

- Press [🔕] to stop the alarm completely.
- Press [🔔] to stop the sound but keep the snooze function activated.
- The phone will automatically turn on and the alarm will sound even if the phone is off.

Night mode

This feature stops the phone from ringing when you do not want to be disturbed. If you set the ring delay, the phone starts ringing after a selected amount of time has passed.

- 1 Press [▲]. → [↕]: Select 🌙. → [↵]
- 2 [↕]: “Phone Settings” → [↵]
- 3 [↕]: “Clock Settings” → [↵]
- 4 [↕]: “Night Mode” → [↵]
- 5 [↕]: “On” → [↵]
- 6 Enter the desired time to start. → [↵]
- 7 Enter the desired time to end. → [↵]
- 8 [↕]: Select the desired ring delay. → [↵]
 - If you select “No Ringing”, the phone never rings during night mode.

Note:

- If you have set the alarm, the alarm sounds even if the night mode is on.

Calendar/Schedule

This feature allows you to see the calendar and store schedule items for a specific date. You can store up to 100 schedule items (maximum 10 items per day). If you set a schedule alarm, an alarm sounds for 30 seconds and a text memo is displayed at the set time.

Creating a new schedule item

- 1 Press [▲]. → [⏏]: Select → [↶]
- 2 [⏏]: “Calendar” → [↶]
- 3 [⏏]: Select the desired date.
 - To go to a specific date:
 - [↶] → [⏏]: “Go to Date” → [↶] → Enter the desired date, month, and year. → [↶]
 - The selected week number is displayed in the bottom right of the calendar.
- 4 [↶] → [⏏]: “Schedule” → [↶]
- 5 [↶] → [⏏]: “Create” → [↶]
- 6 Edit the date if necessary. → [↶]
- 7 Set the desired time. → [↶]
- 8 Enter a text memo (page 21).
- 9 [↶] → [⏏]: “Save” → [↶]
- 10 [⏏]: “On” → [↶]
 - If you prefer not to set a schedule alarm, select “off”, and then go to step 12.
- 11 [⏏]: Select the desired alarm tone. → [↶]
- 12 [↶]
 - The background colour is changed for the date the schedule item is added to.

Note:

- Press [] to stop the alarm completely.
- Press [] to stop the sound but keep the snooze function activated.
- The phone will automatically turn on and the alarm will sound even if the phone is off.

Viewing/editing/erasing a schedule item

- 1 Press [▲]. → [⏏]: Select → [↶]

Basic Operations

- 2 **[↕]**: “Calendar” → **[↶]**
- 3 **[↕]**: Select the desired date.
- 4 **[↶] → [↕]**: “Schedule” → **[↶]**
 - The schedule items are displayed as a list.
- 5 **[↕]**: Select the desired schedule item. → **[↶]**
- 6 **◆ To see the details of each schedule item:**
 - **[↕]**: “Detail” → **[↶]****◆ To edit a schedule item:**
 - **[↕]**: “Edit” → **[↶]** → Continue from step 6 in “Creating a new schedule item”, page 29.**◆ To erase a schedule item:**
 - **[↕]**: “Delete” → **[↶] → [↕]**: “Yes” → **[↶]**

Note:

- Schedule items are not erased automatically even after the set time has passed.

Erasing all schedule items

- 1 Press **[▲]**. → **[↕]**: Select **🔒**. → **[↶]**
- 2 **[↕]**: “Calendar” → **[↶]**
- 3 **[↶] → [↕]**: “Delete All Items” → **[↶]**
- 4 **[↕]**: Select “All until Today” or “All Items”. → **[↶]**
- 5 **[↕]**: “Yes” → **[↶]**

Voice recording

You can record audio to be used as voice memos or ringer tones. Recorded files are saved in the phone’s “Audio” (Audio) folder. Up to 20 sound files can be recorded.

Recording your voice memo/sound

- 1 Press **[▲]**. → **[↕]**: Select **🔒**. → **[↶]**
- 2 **[↕]**: “Voice Recorder” → **[↶]**

- 3 [↕]: “Record” → [↶]
- 4 Press [✕] to stop recording.

Listening to the recorded voice memo/sound

- 1 Press [▲]. → [↕]: Select [🔒]. → [↶]
- 2 [↕]: “Voice Recorder” → [↶]
- 3 [↕]: “List” → [↶]
- 4 [↕]: Select the desired item from the list.
- 5 [↶] → [↕]: “Play” → [↶]

Erasing a voice memo/sound

- 1 Press [▲]. → [↕]: Select [🔒]. → [↶]
- 2 [↕]: “Voice Recorder” → [↶]
- 3 [↕]: “List” → [↶]
- 4 [↕]: Select the desired item from the list.
- 5 [↶] → [↕]: Select “Delete” or “Delete All”. → [↶]
- 6 [↕]: “Yes” → [↶]

Priority call

This feature allows you to ask a registered person for assistance by sending an SMS message and calling them, using [☎] (on the back of the phone). The phone will beep and send an SMS message, and then call the number you stored in the call number list. Store the phone numbers (5 numbers max.) in the list in the desired order of priority.

Note:

- [☎] can be activated even when the phone is closed.
- If you want to turn the buzzer off, see page 44.

Basic Operations

Priority call procedure

- 1 Press and hold **[⇨]** for 3 seconds, or press it 3 times when in standby mode.
- 2 The phone sends your stored SMS message (page 33).
 - To cancel sending an SMS message, press **[✕⏏]**.
- 3 The phone dials the 1st person in the list. Handsfree is turned on.
 - To switch to the receiver, press **[↶]**.
- 4 **If the call is answered**, you can begin your conversation. You can skip to the next person by pressing **[⇨]** for 3 seconds while talking. Press **[✕⏏]** to end the priority call.
OR
If the other party is busy, rejects the call, or does not answer within 20 seconds, the phone automatically dials the next person. The phone continues to send SMS messages and dial numbers in the list in sequence, up to a maximum of 2 times.

Note:

- You can stop the priority call sequence by pressing **[✕⏏]** while dialling. The sequence will continue if you press and hold **[⇨]** again for 3 seconds within 1 minute after you press **[✕⏏]**.

Storing a priority call number

- 1 Press **[▲]**. → **[⇩]**: Select **☰**. → **[↶]**
- 2 **[⇩]**: “Call Settings” → **[↶]**
- 3 **[⇩]**: “Priority Call” → **[↶]**
- 4 **[⇩]**: “Call Number” → **[↶]**
- 5 **[⇩]**: Select the desired position in the call number list.
- 6 **[↶]** → **[⇩]**: “Manual Input” → **[↶]**
 - To add a number from the contacts list:
[⇩]: “Add from List” → **[↶]** → **[⇩]**: Select the desired contact. → **[↶]**
 - If you want to edit the stored number, select “Edit”.

- 7 Enter the party's name (page 21).
- 8 **[↶] → [↕]: "Save" → [↶]**
- 9 Enter the party's phone number. → **[↶]**

Note:

- Storing public institutions such as the police, rescue services, or fire brigade is not recommended.

Storing an SMS message

- 1 Press **[▲]**. → **[↕]**: Select **≡**. → **[↶]**
- 2 **[↕]**: "Call Settings" → **[↶]**
- 3 **[↕]**: "Priority Call" → **[↶]**
- 4 **[↕]**: "Message" → **[↶]**
- 5 Enter a message (page 21).
- 6 **[↶] → [↕]: "Save" → [↶]**

Note:

- Make sure the SMS service centre number is stored (page 41).

Network service call features

Contact your network operator/service provider for details and availability of the services in your area.

Hold

- 1 Press **[↶]** while talking.
- 2 **[↕]**: "Hold" → **[↶]**
- 3 To release hold, press **[↶]**. → **[↕]**: "Retrieve" → **[↶]**

Call waiting

- 1 Press **[↶]** to answer a 2nd call.
 - The 1st call is disconnected if you press **[📞]** while receiving a 2nd call.

Basic Operations

- 2 After the 2nd call is connected, switch between calls by pressing **[↶]**. → **[↕]**: “Swap” → **[↶]**
- 3 Press **[✕⏏]** to end the call.

Note:

- If you want to receive a 2nd call displaying the 2nd caller's information, activate the call waiting feature (page 44).

Conference call

- 1 After the 2nd call is connected, press **[↶]**.
- 2 Select “Merge” and then press **[↶]** to establish a conference call.
 - To split a call during a conference call:
[↕]: Select the desired party. → **[↶]** → **[↕]**: “Split” → **[↶]**
- 3 ♦ **To end a call:**
 - **[↕]**: Select the desired party. → **[✕⏏]**♦ **To end a conference call:**
 - **[↶]** → **[↕]**: “Release Conf.” → **[↶]**♦ **To end all calls:**
 - **[↶]** → **[↕]**: “Release All” → **[↶]**

Security settings

PIN code

PIN1/PIN2 protects your SIM card against unauthorised use. When the PIN1 code request is on, you must enter the PIN1 code each time the phone is turned on.

Important:

- If you enter the incorrect PIN1/PIN2 code 3 times, the SIM card is locked. Enter the 8-digit PUK1 code for PIN1 or the 8-digit PUK2 code for PIN2 to unlock.
- If you enter the incorrect PUK1/PUK2 code 10 times, contact your network operator/service provider for further information.
- Both PIN/PUK numbers are issued by your network operator/service provider.
- The PIN1 code request cannot be set to “Off” with some SIM card types.

- 1 Press **[▲]**. → **[↕]**: Select **✎**. → **[↶]**

- 2 [↕]: “Security” → [↩]
- 3 [↕]: “PIN1 Request” → [↩]
- 4 [↕]: Select the desired setting. → [↩]
- 5 Enter the current PIN1 code (4 to 8 digits). → [↩]

Note:

- If you want to change the PIN code, see page 46.

Phone code

The phone code protects the phone against unauthorised use. When the phone code request is on, you must enter the phone code each time the phone is turned on.

Important:

- The phone will automatically turn off if you enter the incorrect phone code 3 times. If you forget your phone code, contact an authorised service centre.

- 1 Press [▲]. → [↕]: Select 🔒. → [↩]
- 2 [↕]: “Security” → [↩]
- 3 [↕]: “Phone Code Request” → [↩]
- 4 [↕]: Select the desired setting. → [↩]
- 5 Enter the current 4-digit phone code (default: “0000”). → [↩]

Note:

- If you want to change the phone code, see page 46.

Camera

You can take still pictures by activating the camera.

Note:

- When you close the phone while using camera mode, camera mode ends and the phone returns to standby mode.
- If lint accumulates on the camera lens, images may become blurry. In this case, wipe the lens with a soft, dry cloth.

Basic Operations

Taking a picture

The phone can capture images and save them in the “Photos” (Photos) folder in the selected memory location (page 36). For information about camera settings, see page 44.

- 1 Press **[📷]** in standby mode.
- 2 Aim the camera and hold the phone steady.
 - Press **[📷]** to turn the light on when shooting in low light (page 7).
 - To zoom in or zoom out, press and hold **[▲]** or **[▼]**.
 - To adjust the exposure (brightness), press **[+]** or **[-]**.
- 3 Press **[📷]** to take a picture.
 - The following options are available for 5 seconds after taking a picture.
 - “Send”
 - “Delete”
 - After taking pictures, press **[📷]** again to turn off the light (page 7).

Camera options

While using camera mode, the following options are available by pressing **[↶]**:

- “**Image Viewer**”: allows you to view saved images.
- “**Camera Settings**”: allows you to customise the shutter sound, exposure (“**EV**”), and contrast, or configure a delay timer.
- “**Image Settings**”: allows you to set image size and quality.
- “**White Balance**”: allows you to change how colours are captured based on the lighting.
- “**Scene Mode**”: offers night mode for shooting in dim light.
- “**Effect Settings**”: offers photo effects as greyscale, sepia tones, or colour invert.
- “**Storage**”: must be set to “**Memory Card**” if a memory card is inserted to save the pictures. If not, the pictures are saved to the phone.
- “**Restore Default**”: resets your customised settings except for “**Image Viewer**” settings.

Image viewer

To view images taken with the phone's camera, you can activate the image viewer directly in standby mode without activating the camera.

- 1 Press **[▲]**. → **[↕]**: Select . → **[↶]**
- 2 Press **[▼]** or **[▲]** to select the desired file.
- 3 **[↶]** → **[↕]**: **"View"** → **[↶]**
 - The file number and available function keys are shown on the display for 5 seconds after the image appears on the display. To display them again, press any dial key.
 - Press **[▼]** to view the next image and **[▲]** to previous image.
 - Press **[3]** to rotate the image clockwise by 90 degrees. Press **[3]** again to rotate the image back to its original position.
 - Press and hold **[1]** to zoom into an image and **[2]** to zoom out. Some images may not be re-sizable.

Note:

- If you view the saved files after deleting files, the files may not be sorted correctly.

Image viewer options

Press **[▲]**. → **[↕]**: Select . → **[↶]** → **[↕]**: Select an image. → **[↶]**:

- **"View"**: allows you to view saved images.
- **"Image Information"**: shows the file name, saved date and time, file size, etc.
- **"Browser Style"**: allows you to select the way images are displayed when browsing.
- **"Send"**: allows you to send the image file by MMS or Bluetooth data transfer.
- **"Use as"**: allows you to use the image as wallpaper or caller picture for a contact.
- **"Rename"**: allows you to edit the file name (page 21).
- **"Delete"**: deletes the selected file.

Basic Operations

- **“Delete All Files”**: deletes all the saved files in the “Photos” (Photos) folder in the selected memory location (page 36).

File manager

The phone has a file manager that provides a user interface to manage files and folders.

Formatting the phone or memory card

This feature completely erases the phone’s memory or the memory card.

- 1 Press **[▲]**. → **[↕]**: Select **[🔒]**. → **[↶]**
- 2 **[↕]**: **“File Manager”** → **[↶]**
- 3 **[↕]**: Select the desired memory location (root directory).
- 4 **[↶]** → **[↕]**: **“Format”** → **[↶]**
- 5 **[↕]**: **“Yes”** → **[↶]**
 - Wait until **“Done!”** is displayed.

Opening a folder or file in the memory

- 1 Press **[▲]**. → **[↕]**: Select **[🔒]**. → **[↶]**
- 2 **[↕]**: **“File Manager”** → **[↶]**
- 3 **[↕]**: Select the desired memory location (root directory).
- 4 **[↶]** → **[↕]**: **“Open”** → **[↶]**
- 5 **[↕]**: Select the desired folder or file.
- 6 ♦ **When a folder is selected:** **[↶]** → **[↕]**: **“Open”** → **[↶]**
 - ♦ **When a file is selected:** Go to step 7.
- 7 ♦ **To view a picture file:** **[↶]** → **[↕]**: **“View”** → **[↶]**
 - ♦ **To play a sound file:** **[↶]** → **[↕]**: **“Play”** → **[↶]**

◆ To confirm the details of a file: [↶] → [↷]: “Detail” → [↶]

Folder options

When a folder containing a file is selected in the phone or memory card, the following options are available.

If the folder does not contain any files, only “New Folder” is available.

- | | |
|--|--|
| <ul style="list-style-type: none">– “Open”– “New Folder”: creates a new folder in the current folder.– “Rename”– “Delete”: deletes the selected folder. | <ul style="list-style-type: none">– “Sort by”: determines the sort order (folder name, folder type, saved time, or folder size). |
|--|--|

File options

- | | |
|--|--|
| <ul style="list-style-type: none">– “View”– “Image Information”– “Play”– “Send”– “Use as”: allows you to use the file as wallpaper, a phonebook contact, or a contact’s caller picture or ringer depending on the file type.– “New Folder”: creates a new folder in the current folder. | <ul style="list-style-type: none">– “Rename”– “Delete”– “Sort by”: determines the sort order (file name, file type, saved time, or file size).– “Copy”– “Move”– “Delete All Files”: deletes all files in the current folder.– “Detail” |
|--|--|

Basic Operations

Note:

- If you view the saved files after deleting files, the files may not be sorted correctly.

Menu list

Note:

- In the following table, < > indicates the default settings.

“Messages” menus

To enter the following sub-menus, press [▲]. → [↕]: Select . → [↶]

Sub-menu 1	Sub-menu 2	Sub-menu 3	Sub-menu 4	page
Create Message	SMS	–	–	22
	MMS	–	–	22
Inbox	–	–	–	24
Draftbox	–	–	–	–
Outbox	–	–	–	–
Sentbox	–	–	–	–
Delete All	–	–	–	–
Settings	SMS	Service Centre	–	–
		Validity Period ^{*1}	–	–
		Voicemail	Call Voicemail	21
			Edit	20
		Status Report ^{*2} <Off>	–	–
		Reply Path ^{*3} <On>	–	–
		Memory Status	–	–
		Storage Media	–	–
		Save sent SMS <On>	–	–

Customising Your Phone

Sub-menu 1	Sub-menu 2	Sub-menu 3	Sub-menu 4	page
	MMS	Data Account ^{*4}	–	–
		Common Settings	Compose – Slide Time <5> – Creation Mode <Free> – Auto Signature <Off> – Signature	–
			Sending – Delivery Report <Off> – Read Report <Off> – Priority <Medium> – Delivery Time <Immediate> – Send and Save <On>	–
			Retrieval – Home Network <Immediate> – Roaming <As Home> – Filters – Anonymous <Allow> – Advertisement <Allow> – Read Report <On Request> – Delivery Report <On>	–
			Storage	–
			Memory Status	–

*1 Set the time period during which the service centre will try to resend the SMS message if it has not been delivered.

*2 Receive status reports to find out whether your sent SMS messages have been successfully delivered or not.

*3 SMS messages may be sent using another service centre number when this feature is turned on.

*4 These settings are required in order to use MMS to receive data over the network. Configure these settings as needed before sending or receiving MMS data.

“Phonebook” menus

To enter the following sub-menus, press **[▲]**. → **[↕]**: Select . → **[↶]**

Sub-menu 1	Sub-menu 2	Sub-menu 3	page
Contacts	–	–	25
Add New Contact	–	–	25
Speed Dial	–	–	26
One Touch Dial	–	–	26
My Number	–	–	–
Memory Manager	Storage Media <Phone>	–	–
	Memory Status	–	–
	Copy All	–	–
	Delete All	–	–
FDN Phonebook* ¹ <Off> (SIM card dependent)	–	–	–
Service Dial* ² (SIM card dependent)	–	–	–

*1 Activate or deactivate FDN (Fixed Dialling Number). When this feature is activated, only the phone numbers stored in the FDN list can be shown, dialled, or messaged. The PIN2 code is required every time you access the FDN phonebook.

*2 Access the special services of your network operator/service provider (such as customer support, emergency services, etc.) if SDN (Service Dialling Number) is included on your SIM card.

“Call Menu” menus

To enter the following sub-menus, press **[▲]**. → **[↕]**: Select . → **[↶]**

Sub-menu 1	Sub-menu 2	Sub-menu 3	page
Call Log	Incoming Call	–	20
	Outgoing Call	–	
	Missed Call	–	
	Delete All	–	–

Customising Your Phone

Sub-menu 1	Sub-menu 2	Sub-menu 3	page
Call Settings	Priority Call	Call Number	32
		Message	33
		Buzzer <On>	–
	Call Waiting	–	33
	Call Divert ^{*1}	–	–
	Call Barring ^{*2}	Outgoing Barring	–
		Incoming Barring	–
		Barring Password	–
	Show My ID ^{*3} <Network Set>	–	–
	Auto Redial ^{*4} <Off>	–	–
	Answer Mode	Any Key <Off>	–
		Open to Talk <Off>	19

*1 Call divert may not work if call barring is activated.

*2 Call barring may not work if call divert is activated. If you enter the incorrect barring password 3 times, it becomes invalid. Contact your network operator/service provider. The barring password is issued by your network operator/service provider.

*3 When you set this to “Hide ID”, you may not be able to make calls depending on the network.

*4 When this feature is on, the phone automatically redials multiple times under certain conditions (no answer, the other party's line is engaged, etc.). To stop auto redial while redialling, press **[✕⏻]**.

“Camera” menus

To enter the following sub-menus, press **[▲]**. → **[↕]**: Select **[📷]**. → **[↶]** → **[↶]**

Sub-menu 1	Sub-menu 2	Sub-menu 3	page
Image Viewer	–	–	36
Camera Settings	Shutter Sound <Sound 1>	–	36
	EV (Exposure Value) <EV 0>	–	
	Contrast <Medium>	–	
	Delay Timer <Off>	–	
Image Settings	Image Size <Wallpaper (240x320)>	–	36
	Image Quality <Normal>	–	

Customising Your Phone

Sub-menu 1	Sub-menu 2	Sub-menu 3	page
White Balance <Auto>	—	—	36
Scene Mode <Auto>	—	—	36
Effect Settings <Normal>	—	—	36
Storage <Phone>	—	—	36
Restore Default	—	—	36

“Image Viewer” menus

To enter the following sub-menus, press **[▲]**. → **[↕]**: Select . → **[↶]** → **[↕]**: Select an image. → **[↷]**

Sub-menu 1	Sub-menu 2	Sub-menu 3	page
View	—	—	37
Image Information	—	—	37
Browser Style <Matrix Style>	—	—	37
Send	As MMS	—	37
	Via Bluetooth	—	
Use as	Wallpaper	—	37
	Caller Picture	—	
Rename	—	—	37
Delete	—	—	37
Delete All Files	—	—	38

Customising Your Phone

“Settings” menus

To enter the following sub-menus, press [▲]. → [↕]: Select . → [↶]

Sub-menu 1	Sub-menu 2	Sub-menu 3	page
Phone Settings	Clock Settings	Time Zone	–
		Date & Time	–
		Format Settings – Date Format <D/M/Y> – Time Format <24 hours>	–
		Night Mode <Off>	28
		Summer Time <Off>	–
	Display	Brightness <Level 3>	–
		Wallpaper* ¹ – System <Off> – User Defined	–
		Background <Black>	–
		Clock Display <On>	–
		Font Size <Middle>	10
	Language <Auto>* ²	–	–
Network	Select Network	–	–
	Selection Mode* ³ <Auto>	–	–
	GPRS Connection* ⁴ <When Needed>	–	–
Connectivity* ⁵	Data Account	–	–
Security	PIN1 Request	–	34
	Change PIN1* ⁶	–	–
	Change PIN2	–	–
	Phone Code Request <Off>	–	35
	Change Phone Code <0000>	–	–
Reset Settings* ⁷	–	–	–

*1 To select a preset wallpaper pattern or to set this feature to “Off”, select “System”. To select one of your image files as the wallpaper pattern, select “User Defined”.

*2 “Auto” means the phone automatically changes the inserted SIM card language, dictated by the language setting of the SIM card.

*3 Set the phone to automatically roam for a network or to search manually.

Customising Your Phone

“Auto”: The phone automatically searches for the currently available network.

“Manual”: Depending on network situations the phone displays a list of networks that exist in the current location, allowing you to manually select the desired network.

- *4 You can select whether a GPRS connection is always set up or only when needed.
- *5 These settings are required in order to use MMS to receive data over the network. Configure these settings as needed before sending or receiving MMS data.
- *6 When you change the PIN1 code, make sure that the PIN1 code request is set to “On”.
- *7 All settings other than the following items can be reset to factory default:
 - All SMS/MMS messages, service centre number, and validity period
 - Stored contacts, FDN phonebook, and My number
 - All call logs, Priority call settings, Call waiting, Call divert, and Call barring
 - Time zone, date and time, format settings, summer time, PIN1 code request, Phone code request, and Phone code
 - All recorded voice memos and all schedule items stored in the calendar/schedule
 - Connectivity settings (“Data Account”)
 - Bluetooth MAC address

♪ “Profiles” menus

To enter the following sub-menus, press [▲]. → [↔]: Select ♪. → [↶]

Sub-menu 1	Sub-menu 2	Sub-menu 3	page
General	Activate	–	–
	Customize	Ring Type <Ring only>	–
		Ringtones*1 <Ringtone 1>	–
		Message Ringtone*1 <Ringtone 2>	–
		Ringer Volume <Maximum>	–
		Keytone <On>	–
		Audible Dialling <Normal>	11
		Caller ID Readout <Off>	19
	Reset	–	–
Silent	–	–	–

*1 The preset melodies in this product are used with permission of © 2014 Copyrights Vision Inc.

Customising Your Phone

“Tools” menus

To enter the following sub-menus, press [▲]. → [↕]: Select . → []

Sub-menu 1	Sub-menu 2	Sub-menu 3	page
Alarm	–	–	27
File Manager	–	–	38
Bluetooth	On/Off <Off>	–	52
	Visibility <On>	–	52
	My Device	–	52
	My Name	–	52
	Advanced	Audio Path <To BT Device>	52
		Storage <Phone>	52
		MAC Address	52
Voice Recorder	Record	–	30
	List	–	31
FM Radio	–	–	49
Calendar	–	–	29
Telecoil Mode <Off> ^{*1}	–	–	–

*1 Turn this feature on when you activate the Telecoil mode of your hearing aid. You cannot use the frequency control equalizer feature when this feature is on (page 19).

Note:

- If your SIM card includes SAT (SIM Application Toolkit), display shows network operator/ service provider's additional menu in this area. The SIM Toolkit allows the applications existing on the SIM card to interact and operate with your phone. Please contact your network operator/ service provider for further information.

“Ringer Volume” menu

Press [▲]. → [↕]: Select . → [] → Press [+] or [–] to select the desired volume. → []

Using the FM radio

You can connect a corded headset (optional) and listen to the phone's FM radio. You can store your favourite stations in the channel list (30 channels max.).

Note:

- The phone can receive FM radio broadcasts in the frequency range of 87.5 MHz to 108.0 MHz.

Listening to the FM radio

In order to use the FM radio, connect the corded headset (optional) to the phone's headset jack first (page 7, 58).

- 1 Press **[▲]**. → **[↕]**: Select **📶**. → **[↶]**
- 2 **[↕]**: **"FM Radio"** → **[↶]**
 - The tuned frequency is displayed after **"FM"** at the top of the display.
 - When the tuned frequency is stored in the channel list, the station name is displayed in the centre of the display (page 50).
 - To adjust the volume, press **[+]** or **[-]**.
- 3 **◆ To tune manually:**
 - Press **[#⌂]** or **[*]** to tune the radio.
 - ◆ To enter a specific frequency:**
 - **[↶]** → **[↕]**: **"Manual Input"** → **[↶]** → Use **[0]** to **[9]**, and **[#⌂]** (.) to enter the desired frequency. → **[↶]**
 - ◆ To select a frequency in the channel list:**
 - **[↶]** → **[↕]**: **"Channel List"** → **[↶]** → **[↕]**: Select the desired channel. → **[↶]** → **[↕]**: **"Play"** → **[↶]**
 - To store stations in the channel list, see page 50.
 - 4 To turn off the FM radio, press **[↶]**. → **[↕]**: **"Quit FM Radio"** → **[↶]**

Note:

- When the corded headset is disconnected from the phone, the FM radio is deactivated.
- Even if you close the phone, the phone does not return to standby mode.
- To switch the radio output between the corded headset and the phone's speaker (page 7): Press **[↶]** in step 3. → **[↕]**: **"Loudspeaker"** → **[↶]** → **[↕]**: Select the desired setting. → **[↶]**

Connecting to Other Devices

Storing stations in the channel list

You can store the tuned frequencies in the channel list by manual input or auto search.

Storing a station in the channel list by manual input

- 1 Press **[F1]** while the FM radio play screen is displayed.
- 2 **[F2]**: “Channel List” → **[F1]**
- 3 **[F2]**: “<Empty>”
- 4 **[F1]** → **[F2]**: “Edit” → **[F1]**
- 5 Enter the channel name (20 characters max., page 21).
- 6 **[F1]** → **[F2]**: “Save” → **[F1]**
- 7 Use **[0]** to **[9]**, and **[F3]** (.) to enter the desired frequency. → **[F1]**

Note:

- If you do not enter the channel name and proceed to the next operation in step 5, the phone automatically stores the channel name as “New Channel”. Edit the channel name if necessary (page 50).

Storing stations in the channel list by auto search

- 1 Press **[F1]** while the FM radio play screen is displayed.
- 2 **[F2]**: “Auto Search” → **[F1]**
- 3 Press **[F1]** to start auto search and store the stations automatically in the channel list.
 - The channel names are automatically stored as “New Channel”. Edit the channel names if necessary (page 50).

Note:

- When there are tuned frequencies stored in the channel list, the newly tuned frequencies from auto search are overwritten automatically in the channel list.

Editing stations in the channel list

- 1 Press **[F1]** while the FM radio play screen is displayed.
- 2 **[F2]**: “Channel List” → **[F1]**

- 3 **[↕]**: Select the station you want to edit.
- 4 **[↶] → [↕]**: “Edit” → **[↶]**
- 5 Edit the channel name (20 characters max., page 21).
- 6 **[↶] → [↕]**: “Save” → **[↶]**
- 7 Edit the frequency. → **[↶]**

Using a Bluetooth® wireless connection

This phone supports Bluetooth wireless technology and allows the phone to connect to compatible Bluetooth devices (such as headsets, hands-free car kits, etc.) within an approximate range of 10 meters. Consult the manufacturers of other devices to determine their compatibility with this phone.

Note:

- Bluetooth wireless technology uses radio waves and there may be restrictions in some locations. Check with your local authorities.
- Using Bluetooth technology increases the battery power consumption and reduces the battery life. Turn this feature off to save the battery life when you do not use it.
- This phone supports the following Bluetooth profiles: HSP/HFP/OPP/PBAP
- When your phone is connected to both a Bluetooth wireless headset and a corded headset, the corded headset takes priority over the Bluetooth wireless headset for the audio path.

Turning Bluetooth on/off

To use Bluetooth wireless technology, turn this feature on. The default setting is “off”.

- 1 Press **[▲]**. → **[↕]**: Select **[🔒]**. → **[↶]**
- 2 **[↕]**: “Bluetooth” → **[↶]**
- 3 **[↕]**: “On/Off” → **[↶]**
- 4 **[↕]**: Select the desired setting. → **[↶]**

Bluetooth features

To use your phone with another Bluetooth device, you must first register your phone and the other device with each other. This is

Connecting to Other Devices

called “pairing”. To pair, your phone and the other device must be visible to each other.

In the Bluetooth menus, the following features are available;

Press **[▲]**. → **[⬆]**: Select **[🔌]**. → **[🔄]** → **[⬆]**: “Bluetooth” → **[🔄]**:

◆ **“On/Off”**: turns Bluetooth on/off.

◆ **“Visibility”**: makes your phone visible or invisible to other Bluetooth devices.

◆ **“My Device”**: allows you to search and add new Bluetooth devices and lists the paired devices.

– **“Search New”**: searches for new Bluetooth devices and shows a list of discovered devices.

By selecting a paired Bluetooth device from the list, the following options are available.

– **“Connect/Disconnect”**: connects or disconnects the paired audio device.

– **“Auto Connect”**: sets the connected audio device as default.

– **“Rename”**: allows you to edit the name of the paired device.

– **“Unpair”**: unpairs the paired device.

– **“Delete All”**: deletes all the paired devices.

◆ **“My Name”**: allows you to edit your phone’s name that appears in other Bluetooth devices.

◆ **“Advanced”**: allows the following settings.

– **“Audio Path”**: switches the audio path from your phone to the connected audio device or vice versa.

– **“Storage”**: selects the memory location for saving the files received via Bluetooth data transfer.

– **“MAC Address”** (Media Access Control Address): shows your phone’s Bluetooth MAC address information, which may be required when pairing the phone and another Bluetooth device.

Receiving files from another device

When the data is transferred from another device to your phone, there is a message on the display which prompts you to accept it.

Receiving vCard (VCF file) or phonebook data from another device

◆ To receive the data and save as phonebook data:

- 1 Press [↵].
- 2 [↵] → [⬆]: Select “Save to Phone” or “Save to SIM”.
→ [↵]
- 3 Confirm the details of the vCard, then press [↵].

◆ To receive the data and save as vCard (VCF file):

- 1 Press [↵].
- 2 [↵] → [⬆]: “Save as File” → [↵]
- 3 [⬆]: Select the desired memory location (root directory).
- 4 [↵] → [⬆]: “Open” → [↵]
- 5 [↵] → [⬆]: Select the desired folder. → [↵]
 - If you want to create a new folder: [↵] → [⬆]: “New Folder” → [↵]
- 6 [↵] → [⬆]: “Select” → [↵]
- 7 Enter the file name (page 21). → [↵]
- 8 [⬆]: “Save” → [↵]

Receiving files other than vCard (VCF file)

- 1 Press [↵] to start receiving the data.
- 2 Wait for the message that indicates the data was received successfully. → [↵]
 - The file is saved in the “Received” (Received) folder in the selected memory location (page 52).
- 3 The file manager screen is displayed.

Using a USB connection

You can connect your phone to your computer using a USB cable (not supplied). This allows you to copy data between your phone/memory card and your computer.

- 1** Connect the phone to your computer with a USB cable.
- 2** Using your computer, open the desired folder on the phone/memory card and on your computer.
- 3** Using your computer, drag and drop the files and folders you want to copy.

Important:

- Do not disconnect the USB cable from your phone and the computer while data is being transferred, otherwise the data on your phone/memory card may become corrupted. After the data transfer, return to the USB mass storage screen on your computer and safely disconnect your phone from your computer.

Troubleshooting



If you still have difficulties after following the instructions in this section, turn off the phone, remove the battery, then turn it on again after about 1 minute.

Display messages

Display message	Cause/solution
SIM Error	Contact your network operator/service provider for further information.
Limited Service	There is no network service in your current location. Move to another location where your network can be received properly. You can only call the international emergency number “112”.
No Service	There is no network service in your current location. Check the current status and move to a new location with better reception.
PUK1 Blocked! or PUK2 Blocked!	You entered incorrect PUK1/PUK2 code 10 times, therefore PUK1/PUK2 code is blocked. Contact your network operator/service provider.
Error! Charging stopped, see manual.	Charge the battery only in ambient temperatures ranging from 5 °C to 40 °C.
To prevent possible hearing damage, do not listen at high volume levels for long periods.	When you try to set the earphone volume to a certain level while listening to the FM radio, this message will be displayed. Press [↶] to continue adjusting the volume.

Useful Information

General use

Problem	Cause/solution
The phone does not turn on even after installing charged battery.	<ul style="list-style-type: none">● Press [✕ ⏻] for about 2 seconds to turn the power on.
The phone does not work.	<ul style="list-style-type: none">● Make sure the SIM card and battery are installed correctly (page 3).● Fully charge the battery (page 5).
The contacts in the contacts list are not displayed correctly.	<ul style="list-style-type: none">● Only characters supported by this phone can be displayed.
The display is in a language I cannot read.	<ul style="list-style-type: none">● Change the display language (page 46).
The phone beeps and/or  flashes.	<ul style="list-style-type: none">● Battery charge is low. Fully charge the battery (page 5).
I fully charged the battery, but <ul style="list-style-type: none">–  still flashes or– the operating time seems to be shorter.	<ul style="list-style-type: none">● Clean the battery ends (\oplus, \ominus) and the charge contacts with a dry cloth and charge again.● It is time to replace the battery (page 3).
Noise is heard, sound cuts in and out.	<ul style="list-style-type: none">● You are using the phone in an area with high electrical interference. Move to a location away from sources of interference.● The GSM network signal is weak. Check the current status and move to a new location until more bars are visible (page 7).
The phone does not ring.	<ul style="list-style-type: none">● The ringer volume is turned off. Adjust ringer volume (page 48).● Night mode is on. Turn it off (page 28).

Useful Information

Problem	Cause/solution
I cannot make a call.	<ul style="list-style-type: none">● Outgoing calls are barred. Deactivate the outgoing call bar settings (page 44).● Your call is withheld. Change the show my ID setting to a setting other than “Hide ID” (page 44).● Fixed dialling feature is enabled (page 43). Disable it.
I cannot receive a call.	<ul style="list-style-type: none">● Incoming calls are barred. Deactivate the incoming call bar settings (page 44).
I cannot send SMS messages.	<ul style="list-style-type: none">● The phone could not connect to the service centre. Confirm that the correct service centre number is stored (page 41).● Fixed dialling feature is enabled (page 43). Disable it.
I cannot receive SMS messages.	<ul style="list-style-type: none">● SMS message transmission was interrupted. Wait until the SMS message has been sent before using other phone functions.
I cannot receive voicemail message notifications.	<ul style="list-style-type: none">● When the SMS message memory is full, you may not be able to receive any new voicemail message notifications. Erase unnecessary SMS messages to receive new voicemail message notifications (page 24).
I cannot receive SMS messages even though the phone has enough memory.	<ul style="list-style-type: none">● Some kinds of SMS messages can be received only by the SIM card. Check the memory status of the SIM card (page 41) and erase unnecessary SMS messages (page 24).
I cannot receive E-mail messages.	<ul style="list-style-type: none">● This phone only supports SMS/MMS message services. Contact your network operator/service provider for details of this service.

Useful Information

Problem	Cause/solution
Liquid or other form of moisture has entered the phone/charger.	<ul style="list-style-type: none">• Disconnect the AC adaptor from the phone/charger. Remove the SIM card, microSD card, and battery from the phone and leave to dry for at least 3 days. After the phone/charger are completely dry, insert the SIM card, microSD card, and battery into the phone. Then reconnect the AC adaptor to charge fully before use. If the phone does not work properly, contact your place of purchase or nearest Panasonic service centre.

Caution:

- To avoid permanent damage, do not use a microwave oven to speed up the drying process.

General information

- This phone is designed to operate on GSM network - Dual band GSM 900/1800 MHz.
- This equipment is designed for use in Poland, Hungary, Czech, Slovakia, Bulgaria, Croatia, Romania, and Serbia.
- In the event of problems, you should contact your equipment supplier in the first instance.
- For use in other countries, please contact your equipment supplier.

Declaration of Conformity:

- Panasonic Corporation declares that the radio equipment type (KX-TU329) is in compliance with Directive 2014/53/EU.

The full text of the EU declaration of conformity is available at the following internet address:
<http://www.ptc.panasonic.eu/doc>

Contact to Authorised Representative:

Panasonic Testing Centre
Panasonic Marketing Europe GmbH
Winsbergring 15, 22525 Hamburg, Germany

Additional/replacement accessories

Please contact your place of purchase or Panasonic sales office for sales information.

Accessory item	Model number
Rechargeable battery	BJ-LT100010 <ul style="list-style-type: none">• Lithium Ion (Li-Ion) battery.
Headset	RP-TCM125

Sales department

■ Czech / Česká republika

Produkt Panasonic

Nákupní doklad si prosím uschovejte.

Informace a podmínky záruky pro tento produkt

jsou k dispozici na www.panasonic.com/cz
nebo na následujících telefonních číslech:

236032911 – číslo pro volání z pevné linky
panasonic.praha@eu.panasonic.com

Distribuce v České republice:

Panasonic Marketing Europe GmbH
Organizační složka Česká Republika

Thámová 289/13, 18600 Praha 8
Česká republika

■ Slovakia / Slovenská republika

Výrobok Panasonic

Odložte si doklad o kúpe.

Záručné podmienky a informácie o tomto

výrobku sú dostupné na www.panasonic.com/sk
alebo na nasledujúcich telefónnych číslach:

220622911 – číslo pre volania z pevnej siete
panasonic.bratislava@eu.panasonic.com

Distribúcia na Slovensku:

Panasonic Marketing Europe GmbH
Organizační složka Česká Republika

Thámová 289/13, 18600 Praha 8
Česká republika

■ Romania

Produs Panasonic

Acest produs este acoperit de garanția

E-Guarantee Panasonic. Vă rugăm să păstrați

chitanța de achiziționare. Condițiile garanției

și informațiile despre acest produs sunt

disponibile la www.panasonic.com/ro sau la
următoarele numere de telefon:

021 316 3165 / 021 316 4187 - număr pentru
apeluri din rețele fixe (terestre)

suport.clienti@eu.panasonic.com

Distribuție în România:

Panasonic Marketing Europe GmbH
Organizační složka Česka Republika

Thámová 289/13, 18600 Praha 8
Republica Cehá

■ Poland / Polska

Produkt Panasonic

Produkt objęty jest E-Gwarancją Panasonic.

Prosimy o zachowanie dowodu zakupu.

Warunki gwarancji oraz informacje o produkcji

są dostępne na stronie

www.panasonic.com/pl lub pod numerami

telefonów: 801 003 532 - numer dla połączeń z
sieci stacjonarnej

22 295 37 27 - numer dla połączeń z sieci

stacjonarnej oraz komórkowej

Dystrybucja w Polsce:

Panasonic Marketing Europe GmbH

(Spółka z ograniczoną odpowiedzialnością)

Oddział w Polsce ul. Wołoska 9a, 02-583

Warszawa

■ Hungary / Magyarország

Panasonic termék

Kérjük őrizze meg a fizetési bizonylatot.

E termékre vonatkozó jótállási feltételek és információk

elérhetőek a www.panasonic.com/hu oldalon,

illetve az alábbi telefonszámon:

+36 40 201 006 - Helyi hívásnak megfelelő díjazásért hívható kék szám.

customer.budapest@eu.panasonic.com

Disztribúció Magyarországon:

Panasonic Marketing Europe GmbH
Organizační složka Česka Republika

Thámová 289/13, 18600 Praha 8
Csehország

Useful Information

Declaration of conformity form

Panasonic

Declaration of Conformity

Document Number: PCTP-140128-04

Manufacturer

Name : Panasonic System networks Co., Ltd.
Address : 1-82, 4-chome, Minoshima,
Hakata-ku, Fukuoka, 812-8531
Japan

Object of Declaration

< A >

Product Name : GSM Easy Use Mobile Phone
Trade Name : Panasonic
Model Number : KX-TU339; KX-TU349; KX-TU329; (AG Adaptor); PNLV230CE; PNLV230E
(Charger Unit); PNLG1039; (Battery); BJ-LT100010

CE Requirements

This declaration of conformity is issued under the sole responsibility of manufacturer. The object of the declaration described above is in conformity with the requirements of the following EU legislation and harmonized standards:

Council Directive(s)	: 2014/53/EU 2009/125/EC 2011/65/EU	RED ErP RoHS	< B >
Commission Regulation(s)	: (EC) No.278/2009 (EC) No.1275/2008 (EU) No.801/2013	Implementing measures for ErP Directive Implementing measures for ErP Directive Implementing measures for ErP Directive	
Council Recommendation(s)	: 1999/519/EC	EMF	

Harmonized Standard(s) : < C >
EN 60950-1:2006 +A11:2009 +A1:2010 +A12:2011 +A2:2013; EN 50380 :2001 +A1:2012
EN 50566:2013; EN 62479:2010; EN 301 489-1 V1.9.2; EN 301 489-7 V1.3.1
EN 301 489-17 V2.2.1; EN 55032:2012; EN 55020 :2007 +A11:2011; EN 300 328 V1.9.1
EN 301 511V12.1.1; EN 50563 :2011 +A1:2013; EN 50564 :2011; EN 50581 :2012

Additional Information

< D >

20 October, 2016

Date of Issue / Signature

Nobuhiro Sanno / Senior Tech. Reg. Manager
Printed Name / Title

20. Okt. 2016

Date of Issue / Signature

Wolfgang Hoepfner

Authorised Representative
Panasonic Testing Centre
Panasonic Marketing Europe GmbH
Winsbergstr. 15, 22525 Hamburg, Germany

Useful Information

Przedmiot deklaracji opisany wyżej <A> jest zgodny z wymogami następujących przepisów prawnych UE i zharmonizowanych norm <C> potrzebne informacje zostały przekazane <D>.

A nyilatkozat fent említett tárgya <A> a következő EU rendeletek és harmonizált szabványok <C> követelményeivel összhangban van. És egyéb tájékoztató jellegű információ, ha felmerül <D>.

Cíl výše uvedeného prohlášení <A> je v souladu s požadavky následujících legislativních ustanovení EU a harmonizovanými normami <C> a další poskytnuté informace v případě <D>.

Cieľ vyššie uvedeného prehlásenia <A> je v súlade s požiadavkami nasledujúcich legislatívnych ustanovení EÚ a harmonizovanými normami <C> a ďalšie poskytnuté informácie keď dostupné <D>.

Целта на горепосочената декларация <A> съответства на изискванията на следните законодателни актове на ЕС и хармонизираните стандарти <C> и друга предоставена информация, при наличие на такава <D>.

Predmet gore navedene izjave <A> je sukladan sa zahtjevima pravnih propisa EU u nastavku i harmoniziranih normi <C> i druge pružene informacije, ukoliko ih ima <D>.

Obiectul declarației descris mai sus <A> este în conformitate cu cerințele următoarelor legislații UE și standardele armonizate <C> și alte informații furnizate în cazul în care sunt <D>.

Index

Index

- A** Alarm: 27
 - Answer mode
 - Any key: 44
 - Open to talk: 44
 - Answering calls: 19
 - Audible dialling: 11, 47
 - Auto redial: 44
- B** Battery: 3, 7
 - Bluetooth: 51
- C** Calendar: 29
 - Call barring: 44
 - Call divert: 44
 - Call log: 18, 20
 - Call waiting: 33
 - Caller ID readout: 19, 47
 - Camera: 35
 - Camera settings: 44
 - Conference call: 34
 - Connectivity: 46
- D** Date and time: 46
 - Display
 - Background: 46
 - Brightness: 46
 - Clock: 46
 - Font size: 10, 46
 - Language: 46
 - Wallpaper: 46
 - Display message: 55
- E** Emergency call: 55
- F** File manager: 38
 - Fixed dialling number (FDN): 43
 - FM radio: 49
 - Frequency control equalizer: 19
- G** GPRS connection: 46
- H** Handsfree: 19
 - Hold: 19, 33
- I** Image viewer: 37
 - International call: 7, 18
- K** Keytone: 47
- L** LED light: 7
- M** Making calls: 18
 - Menu list: 41
 - microSD card: 3
 - Missed calls: 19
 - MMS message: 22
 - MMS settings: 42
 - Mute: 19
 - My number: 43
- N** Network: 46
 - Night mode: 28
- O** One touch dial: 18, 26
- P** Pause: 18
 - Phone code: 35, 46
 - Phonebook: 18, 25
 - Phonebook settings: 43
 - PIN: 34, 46
 - Power on/off: 10
 - Priority call: 31
 - PUK: 34, 55
- R** Rejecting a call: 19
 - Reset settings: 46
 - Ringer profiles: 47
 - Ringer tone: 47
- S** Schedule: 29
 - Service dialling number (SDN): 43
 - Show my ID: 44
 - Silent mode: 7, 47
 - SIM application toolkit (SAT): 48
 - SIM card: 3
 - SMS message: 22
 - SMS settings
 - Reply path: 41

- Service centre: 41
- Status report: 41
- Validity period: 41
- Speed dial: 18, 26
- Summer time: 46
- T** Telecoil (T-coil) mode: 48
- Text input: 21
- Troubleshooting: 55
- U** USB
 - Charging: 5
 - Connecting to a computer: 54
- V** Vibration: 47
- Voice recording: 30
- Voicemail: 20
- Volume
 - Receiver: 6
 - Ringer: 6, 48
 - Speaker: 6

For your future reference

We recommend keeping a record of the following information to assist with any repair under warranty.

Serial No.	Date of purchase
(found on the carton box or in the battery compartment)	
Name and address of dealer	

Attach your purchase receipt here.

Panasonic Corporation

1006, Oaza Kadoma, Kadoma-shi, Osaka 571-8501, Japan
<http://www.panasonic.com>

© Panasonic Corporation 2016



PNQX8228XA

PNQX8228XA PP0816YK2027 (E)